

Installation guide for LexCom Home Power Supply

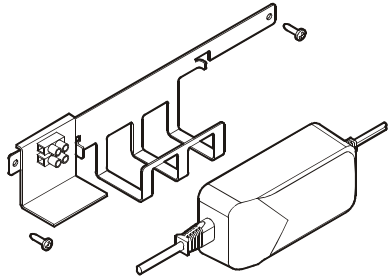

The package includes:

- 1 Power Supply
- 1 Mains lead
- 1 Holder with a connecting sleeve mounted
- 2 Combi-slotted screws

Application

The power supply is applied exclusively for LexCom Home and is mounted in either the external or the flush-mounted distribution board.

The power supply is equipped with two output leads to connect to the Data Hub and the aerial module (the telephone module does not require power supply).

Construction

The device is a Switch Mode Power Supply (SMPS) with high efficiency.

The holder and the two combi-slotted screws are used for mounting the power supply in the distribution board.

Installation

Please note:

1. The plugs of the power supply must not be inserted in the telephone module's line connections. Only use the power supply for the Data Hub and aerial modules.
2. The mains lead must not be fed in a concealed conduit.
3. The connectors are protected against incorrect polarisation through coding.
4. The relevant installation method depends on the type of distribution board applied, external or a flush-mounted. The two methods are treated separately in the following.

External distribution board

To connect to an external wall outlet the mains lead is guided from outside through the top or the bottom of the distribution board and under the holder of the power supply. Subsequently, the appliance connector is inserted in the power supply (see figure 1).

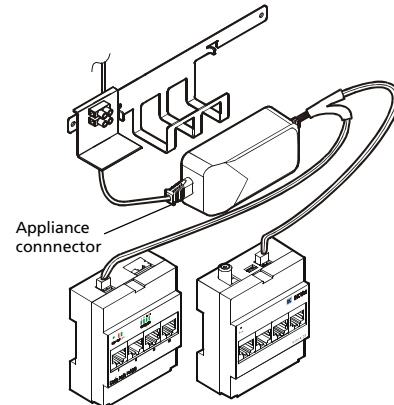

Figure 1: Power Supply for Data Hub and aerial module in external distribution board

The power supply is finally placed on the upper stays of the base plate as shown in figure 2. The connecting sleeve is not required for this method of installation.

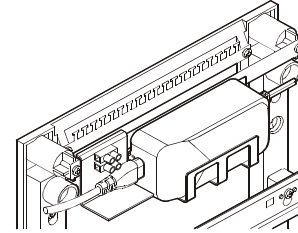

Figure 2: Power supply mounted in external distribution board

Alternatively, the power supply can be connected to the permanent installation as described in the following section, "flush-mounted distribution board".

Flush-mounted distribution board

As shown in figure 3 the connecting sleeve is applied for this installation: Cut through the mains lead about 12 cm from the appliance connector. The cut-off mains lead is discarded whereas the remaining 12 cm long lead is stripped and connected to one end of the sleeve. The sleeve's other end is connected to the permanent installation in conformity with installation regulations.

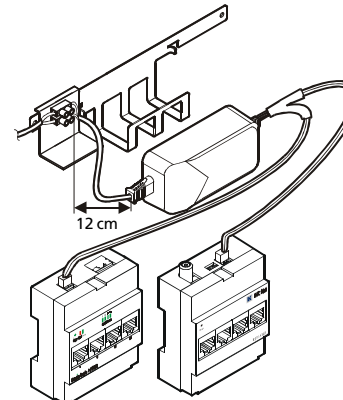

Figure 3: Installing power supply by use of mounting sleeve

The appliance connector is inserted in the power supply, which is placed on the upper stays of the base of the recessed cabinet as shown in figure 4.

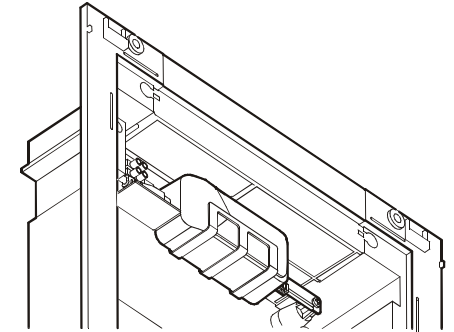

Figure 4: Power supply mounted in flush-mounted distribution board

Technical data

Input voltage	100-250 V a.c. at 47-63 Hz
Output voltage	12 V d.c. +/- 5 %
Max. load	18 W
Ripple	50 mV _{pp}
Efficiency	85 %
Precautions	Short circuit protected at output
Ambient operating temperature	+5° C to +40° C
Air humidity	5 % RH to 95 % RH
Dimensions (excl. holder)	WDH = 103x50x37 mm
Weight (excl. holder)	191 g
Regulations	EN 50082-1, EN 55022 EN 60950 (applied with data Hub H100) EN 60065 (applied with aerial module A100)